

Licensing Sub-Committee Report

Item No:	
Date:	12 November 2015
Licensing Ref No:	15/06558/LIPN - New Premises Licence
Title of Report:	Timber Yard Ground Floor and Basement 4 Noel Street London W1F 8GB
Report of:	Director of Public Protection and Licensing
Wards involved:	West End
Policy context:	City of Westminster Statement of Licensing Policy
Financial summary:	None
Report Author:	Mrs Sumeet Anand-Patel Senior Licensing Officer
Contact details	Telephone: 020 7641 2737 Email: sanandpatel@westminster.gov.uk

1. Application

1-A Applicant and premises			
Application Type:	New Premises Licence, Licensing Act 2003		
Application received date:	4 August 2015 (validated on 25 th September 2015)		
Applicant:	Timberyard Limited		
Premises:	Timber Yard		
Premises address:	Ground Floor and Basement 4 Noel Street London W1F 8GB	Ward:	West End
		Stress Area:	West End
Premises description:	This premises shall operate as a coffee shop with the offering of alcohol and a space to screen films for the public and/or privately booked events.		
Premises licence history:	This premises has not previously benefitted from a licence under the Licensing Act 2003.		
Applicant submissions:	<p><u>The applicant sent an emails to two of the objectors:</u></p> <p>Date: 11th October 2015</p> <p>To: David Rushmore and Steve Chambers</p> <p>As new neighbours we would welcome the chance to say hello properly and wondered if perhaps we could meet in person, as we did with Sally Thomas and PC Reaz Guerra. We completely understand your concerns and wish to reassure you on all counts if at all possible. Would you be kind enough to allow us the opportunity to clarify our business model and explain the work that we have been doing with the Licensing Team and the comprehensive conditions that we will be accepting on our licence?</p> <p>As a speciality coffee shop and creative workspace we really believe that Timberyard will be a positive introduction to Noel Street and have minimal impact on crime and disorder in the area as a whole. We are of course eager to explain our strong community intentions and in doing so we hope to remove any doubts and fears that The Soho Society may currently be feeling.</p> <p>Best, Darren Elliott Tea, coffee, work and play. Re-Imagined. Timberyard Operations Director</p>		

1-B Proposed licensable activities and hours							
Regulated Entertainment - Films:				Indoors, outdoors or both			Indoors
Day:	Mon	Tues	Wed	Thur	Fri	Sat	Sun
Start:	08:00	08:00	08:00	08:00	08:00	08:00	08:00
End:	23:00	23:00	23:00	23:00	23:00	23:00	23:00
Seasonal variations:			N/A				
Non-standard timings:			N/A				

Sale by retail of alcohol				On or off sales or both:			On
Day:	Mon	Tues	Wed	Thur	Fri	Sat	Sun
Start:	11:00	11:00	11:00	11:00	11:00	11:00	12:00
End:	23:00	23:00	23:00	23:00	23:00	23:00	22:00
Seasonal variations:			N/A				
Non-standard timings:			N/A				

Hours premises are open to the public							
Day:	Mon	Tues	Wed	Thur	Fri	Sat	Sun
Start:	08:00	08:00	08:00	08:00	08:00	08:00	08:00
End:	23:00	23:00	23:00	23:00	23:00	23:00	23:30
Seasonal variations:			N/A				
Non-standard timings:			N/A				
Adult Entertainment:			None				

2. Representations

2-A Responsible Authorities	
Responsible Authority:	Metropolitan Police Service
Representative:	PC Reaz Guerra
Received:	29 th September 2015

With reference to the above application, I am writing to inform you that the Metropolitan Police, as a Responsible Authority, will be objecting to this application as it is our belief that if granted the application would undermine the Licensing Objectives.

The venue is situated in the West End Stress Area, a locality where there is traditionally high crime and disorder. We have concerns that this application will cause further policing problems in an already demanding area.

An officer from this unit will be in contact with you shortly to discuss the application. However it is for the applicant to prove that this application will not add to the cumulative impact problems already experienced in this area.

It is for these reasons that we are objecting to the application.

Should you wish to discuss the matter further please contact PC Reaz Guerra on **0207 641**

1709 or via email, rguerra@westminster.gov.uk.

Note: conditions have been agreed between the applicant and the Police; these are included in Appendix 4.

Responsible Authority:	Environmental Health Service
Representative:	Sally Thomas
Received:	29 th September 2015

I refer to the application for a new application for the above premises.

The premises are situated in the West End Stress Area as stated in City of Westminster's Statement of Licensing Policy.

The applicant has submitted the following plans for the premises:

- ◆ Basement Floor Layout: drawing number 2015-08/04-101 rev A, dated April 2015.
- ◆ Ground Floor Layout: drawing number 2015-08/04-201 rev A, dated April 2015.

This representation is based on the plans and Operating Schedule submitted.

The applicant is seeking the following licensable activities in the basement and ground floor:

1. The Supply of Alcohol for consumption 'on' the premises Monday to Saturday 11:00-23:00 hours and Sunday 12:00-22:00 hours.
2. To the provision of regulated entertainment of films 'indoors' Monday to Sunday 08:00-23:00 hours.

I wish to make the following representations in relation to the above application:

1. The Supply of Alcohol will have the likely effect of causing an increase in Public Nuisance in the stress area and may impact on Public Safety.
2. The provision of film may have the likely effect of causing an increase in Public Nuisance in the area stress area and may impact on Public Safety.

The plans indicate 4 WCs and 2 accessible WCs. You will need to ensure the capacity is compliant with the British Standard 6465-1:2009 Table 10 or 11, depending on how you plan to operate the premises. Please confirm the proposed capacity on both floors.

The applicant has provided additional information and conditions with the operating schedule which are being considered, but does not fully address the concerns of Environmental Health. The premises are required to be inspected by the Council's Environmental Health Service to confirm that they are satisfied that the premises are suitable, in relation to addressing the licensing objectives of Public Safety and Prevention of Public Nuisance. The applicant is advised to contact the undersigned to arrange a suitable time for inspection of the premises.

The granting of this application as presented would have the likely effect of causing an increase in Public Nuisance in the stress area and may impact on Public Safety.

Should you wish to discuss the matter further please do not hesitate to contact me.

Note: conditions have been agreed between the applicant and EH; these are included in Appendix 4.

2-B Other Persons	
--------------------------	--

Name:	Ms Katrina Wood
--------------	-----------------

Address and/or Residents Association:	1 Noel Street London W1F 8GA
----------------------------------------------	------------------------------------

Received:	22 nd October 2015
------------------	-------------------------------

I have for ten years lived at 1Noel Street, W1F 8GA, I have increasingly had to suffer the noise of building in this area and air conditioning added to the back of the building directly outside my bedroom door onto the small verandah. The earlier building at 2 -4 Noel Street made it impossible to even do a telephone call because of the drilling I endured for months. There will be a significant list of calls and visits from the Noise Dept who help intervene to ensure the law was not flouted. This particular building at 4 Noel Street has also extended their area out at the back of the building. I am very concerned that I will be constantly dealing with noise from an establishment which has an alcohol licence that is right next door to me. This does not even reflect on the added noise of traffic directly below my windows that will be increased by this venue .

This is a mixed residential and business area and some lid needs to be put on the ever building disruption this causes for those of us who have lived long term on this street.

I look forward to you response, with thanks.

Katrina Wood

Name:	Mr David Rusholme
--------------	-------------------

Address and/or Residents Association:	Flat 3 195 Wardour St London W1F 8ZG
----------------------------------------------	-----------------------------------------------

Received:	8 th September 2015 (carried forward into the new consultation period)
------------------	-----------------------------------------------------------------------------------

I object to the serving of alcohol at these premises due to potential for noise from the premises and from customers leaving the premises.

I also particularly object to the proposed opening hours from 08.00 to 23.00 and weekend opening.

Several residential properties back onto the premises and the potential for noise especially through the light well is significant.

Noel St has no other licenced premises. It is a narrow street with narrow pavements.

This objection is made in the context that as a Soho resident it is realistic to expect some noise and disruption. These proposals are not propionate to the character of the area and potential for late night and weekend noise.

Name:	Mr Steve Chambers
--------------	-------------------

Address and/or Residents Association: The Soho Society
 St Annes Tower
 55 Dean Street
 London
 W1D 6AF

Received: 16th September 2015 (carried forward into the new consultation period)

I write to make a relevant representation to the above application on behalf of The Soho Society. The Soho Society objects to this application as it is currently presented, on the grounds of prevention of public nuisance, prevention of crime and disorder and cumulative impact in the West End Stress Area.

About The Soho Society

The Soho Society is a charitable company limited by guarantee established in 1972. The society is a recognised amenity group and was formed to make Soho a better place to live, work or visit by preserving and enhancing the area's existing diversity of character and uses, and by improving its facilities, amenities and environment. In particular, the society supports the Westminster City Council's policies, including the cumulative impact policy, as set out in the Statement of Licensing Policy.

Application summary

Activity	Indoors/Outdoors	Alcohol Consumed	Time Period	From	To
Exhibition of a Film	Indoors		Monday to Sunday	08:00 AM	11:00 PM
Sale by Retail of Alcohol	Indoors	On Premises	Monday to Saturday	11:00 AM	11:00 PM
Sale by Retail of Alcohol	Indoors	On Premises	Sunday	12:00 PM	10:00 PM

New licensed premises in the West End Stress Area

The proposal is for a new licensed premises in the West End Stress Area. The new Sale by Retail of Alcohol On Premises licensable activity is of particular concern, with reference to Westminster City Council stress area and cumulative impact policy. Such new licenses (in particular where not ancillary to food) should be prohibited. These venues destroy residential amenity over a wide area through noise nuisance as patrons disperse. It is noted the conditions for this application do not make reference to service with food. It is therefore felt necessary that should this license be permitted, conditions must be applied to prevent problematic vertical drinking:

MC39 The supply of alcohol shall be by waiter or waitress service only.

MC41 Substantial food and non-intoxicating beverages, including drinking water, shall be available in all parts of the premises where alcohol is sold or supplied for consumption on the premises.

Licensing policy

This area has been identified by the Westminster City Council (2.4.1 of the Statement of Licensing Policy, as amended) as under stress because the cumulative effect of the

concentration of late night and drink led premises and night cafes has led to serious problems of disorder and/or public nuisance affecting residents, visitors and other businesses.

The policies in relation to the stress areas are directed at the global and cumulative effects of licences on the area as a whole (2.4.5 of the policy). The policies are intended to be strict and will only be overridden in genuinely exceptional circumstances (2.4.2 of the policy). The growth in the entertainment industry in Soho has led to a marked deterioration in the quality of life and well-being of local residents and it has jeopardised the sustainability of the community. Soho has a substantial residential community and many of these residents suffer from problems such as, but not limited to, high levels of noise nuisance, problems with waste, urinating and defecating in the streets, threats to public safety, anti-social behaviour, crime and disorder and the change in character of historic areas. For the reasons I have set out, we believe that the application, if granted in its present form, would fail to promote the licensing objectives of prevention of public nuisance and prevention of crime and disorder. I respectfully urge the Licensing Sub-Committee to reject this application.

Please let me know if any proposals are made to amend the application; particularly in respect of the hours sought or any further conditions proposed.

Yours faithfully,

David Gleeson

Licensing Chair

3. Policy & Guidance

The following policies within the City Of Westminster Statement of Licensing Policy apply:

Policy STR1 applies:

(i) It is the Licensing Authority's policy to refuse applications in the Stress Areas for: pubs and bars; fast food premises, and premises offering facilities for music and dancing; other than applications to vary hours within the Core Hours under Policy HRS1.

(ii) Applications for other licensable activities in the Stress Areas will be subject to other policies and must demonstrate that they will not add to cumulative impact in the Stress Areas.

Policy COMB1 applies:

(i) Where a premises proposes to operate as a combined use premises applications will be considered on their merits with regard to each of the relevant policies e.g. Policies CD1, PS1, PN1 CH1 STR1 and HRS1.

(ii) The Licensing Authority will take into account the current and proposed use of the premises when considering what weight is to be given to the relevant uses and policies.

It will take into account what is the primary use of the premises, if any, and which licensable activities are proposed outside the core hours (see policy HRS1).

(iii) It will consider any premises which include any pub or bar use

	or provide facilities for fast food and drink or for music and dancing primarily under the policies specific to those uses e.g. PB1&PB2, FFP1 & FFP2, MD1 & MD2.
Policy PB2 applies:	It is the Licensing Authority's policy to refuse applications in the Stress Areas other than applications to vary hours within the Core Hours under Policy HRS1.

4. Appendices

Appendix 1	Premises plans
Appendix 2	None provided
Appendix 3	Premises history
Appendix 4	Proposed conditions
Appendix 5	Residential map and list of premises in the vicinity
Appendix 6	Photos of the premises

Report author:	Mrs Sumeet Anand-Patel Senior Licensing Officer
Contact:	Telephone: 020 7641 2737 Email: sanandpatel@westminster.gov.uk

APPENDIX 1

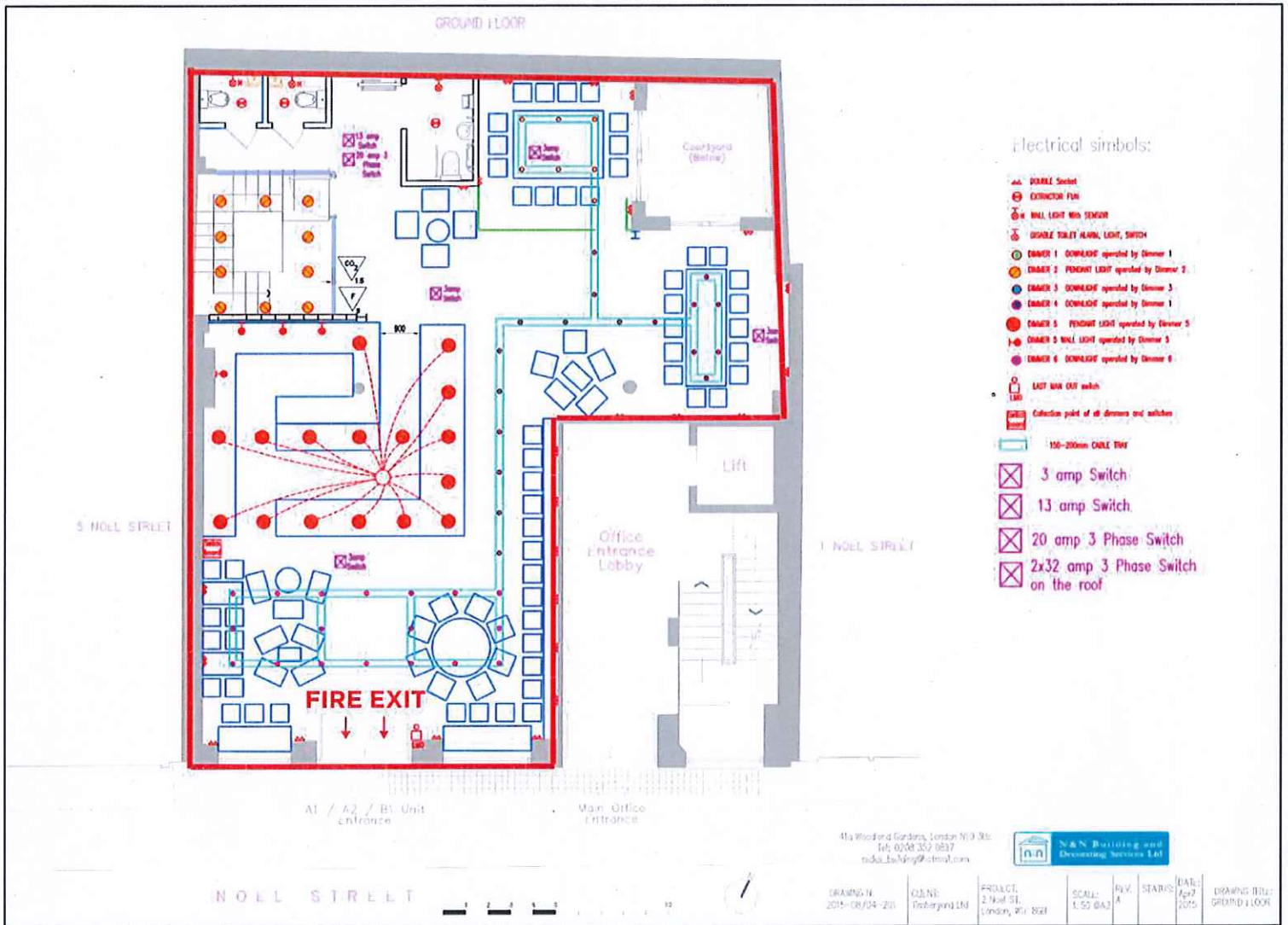

Electrical symbols:

- DOUBLE SOCKET
- EXTINGUISHER PIN
- WALL LIGHT WITH SENDER
- DIMMER TOILET ALARM, LIGHT, SWITCH
- DIMMER 1 PENDANT LIGHT operated by Dimmer 1
- DIMMER 2 PENDANT LIGHT operated by Dimmer 2
- DIMMER 3 PENDANT LIGHT operated by Dimmer 3
- DIMMER 4 DOWNLIGHT operated by Dimmer 1
- DIMMER 5 PENDANT LIGHT operated by Dimmer 5
- DIMMER 6 WALL LIGHT operated by Dimmer 5
- DIMMER 6 DOWNLIGHT operated by Dimmer 6
- LAST MAN OUT switch
- Collection point of all dimmers and switches
- 150-200mm CABLE RUN
- 3 amp Switch
- 13 amp Switch
- 20 amp 3 Phase Switch
- 2x32 amp 3 Phase Switch on the roof

Premises Licensing History

Application	Details of Application	Date Determined	Decision
New Application 15/06558/LIPN	Current Application	Pending	
Temporary Event Notice 15/09267/LITENP	Application to permit the sale of alcohol and the provision of regulated entertainment on 2 nd November 2015 from 12:00 to 22:00	30.10.2015	Notice Granted
Temporary Event Notice 15/09625/LITENP	Application to permit the sale of alcohol and the provision of regulated entertainment on 9 th November 2015 from 12:00 to 22:00	04.11.2015	Notice Granted
Temporary Event Notice 15/09638/LITENP	Application to permit the sale of alcohol and the provision of regulated entertainment on 16 th November 2015 from 12:00 to 22:00	04.11.2015	Notice Granted

There is no appeal history.

CONDITIONS CONSISTENT WITH THE OPERATING SCHEDULE AND CONDITIONS PROPOSED BY A PARTY TO THE HEARING

When determining an application for a new premises licence under the provisions of the Licensing Act 2003, the licensing authority must, unless it decides to reject the application, grant the licence subject to the conditions which are indicated as mandatory in this schedule.

At a hearing the licensing authority may, in addition, and having regard to any representations received, grant the licence subject to such conditions which are consistent with the operating schedule submitted by the applicant as part of their application, or alter or omit these conditions, or add any new condition to such extent as the licensing authority considers necessary for the promotion of the licensing objectives.

This schedule lists those conditions which are consistent with the operating schedule, or proposed as necessary for the promotion of the licensing objectives by a responsible authority or an interested party as indicated. These conditions have not been submitted by the licensing service but reflect the positions of the applicant, responsible authority or interested party and have not necessarily been agreed

Mandatory Conditions

1. No supply of alcohol may be made at a time when there is no designated premises supervisor in respect of this licence.
2. No supply of alcohol may be made at a time when the designated premises supervisor does not hold a personal licence or the personal licence is suspended.
3. Every supply of alcohol under this licence must be made or authorised by a person who holds a personal licence.
4.
 - (1) The responsible person must ensure that staff on relevant premises do not carry out, arrange or participate in any irresponsible promotions in relation to the premises.
 - (2) In this paragraph, an irresponsible promotion means any one or more of the following activities, or substantially similar activities, carried on for the purpose of encouraging the sale or supply of alcohol for consumption on the premises—
 - (a) games or other activities which require or encourage, or are designed to require or encourage, individuals to;
 - (i) drink a quantity of alcohol within a time limit (other than to drink alcohol sold or supplied on the premises before the cessation of the period in which the responsible person is authorised to sell or supply alcohol), or
 - (ii) drink as much alcohol as possible (whether within a time limit or otherwise);
 - (b) provision of unlimited or unspecified quantities of alcohol free or for a fixed or discounted fee to the public or to a group defined by a particular characteristic in a manner which carries a significant risk of undermining a licensing objective;
 - (c) provision of free or discounted alcohol or any other thing as a prize to encourage or reward the purchase and consumption of alcohol over a period of 24 hours or

less in a manner which carries a significant risk of undermining a licensing objective;

- (d) selling or supplying alcohol in association with promotional posters or flyers on, or in the vicinity of, the premises which can reasonably be considered to condone, encourage or glamorise anti-social behaviour or to refer to the effects of drunkenness in any favourable manner;
 - (e) dispensing alcohol directly by one person into the mouth of another (other than where that other person is unable to drink without assistance by reason of a disability).
5. The responsible person must ensure that free potable water is provided on request to customers where it is reasonably available.
6. (1) The premises licence holder or club premises certificate holder must ensure that an age verification policy is adopted in respect of the premises in relation to the sale or supply of alcohol.
- (2) The designated premises supervisor in relation to the premises licence must ensure that the supply of alcohol at the premises is carried on in accordance with the age verification policy.
- (3) The policy must require individuals who appear to the responsible person to be under 18 years of age (or such older age as may be specified in the policy) to produce on request, before being served alcohol, identification bearing their photograph, date of birth and either—
- (a) a holographic mark, or
 - (b) an ultraviolet feature.
7. The responsible person must ensure that—
- (a) where any of the following alcoholic drinks is sold or supplied for consumption on the premises (other than alcoholic drinks sold or supplied having been made up in advance ready for sale or supply in a securely closed container) it is available to customers in the following measures—
 - (i) beer or cider: ½ pint;
 - (ii) gin, rum, vodka or whisky: 25 ml or 35 ml; and
 - (iii) still wine in a glass: 125 ml;
 - (b) these measures are displayed in a menu, price list or other printed material which is available to customers on the premises; and
 - (c) where a customer does not in relation to a sale of alcohol specify the quantity of alcohol to be sold, the customer is made aware that these measures are available.

A responsible person in relation to a licensed premises means the holder of the premise licence in respect of the premises, the designated premises supervisor (if any) or any individual aged 18 or over who is authorised by either the licence holder or designated premises supervisor. For premises with a club premises certificate, any member or officer of the club present on the premises in a capacity that which enables him to prevent the supply of alcohol.

- 8(i) A relevant person shall ensure that no alcohol is sold or supplied for consumption on or off the premises for a price which is less than the permitted price.
- 8(ii) For the purposes of the condition set out in paragraph 8(i) above -
- (a) "duty" is to be construed in accordance with the Alcoholic Liquor Duties Act 1979;
 - (b) "permitted price" is the price found by applying the formula -
$$P = D + (D \times V)$$

Where -
 - (i) P is the permitted price,
 - (ii) D is the amount of duty chargeable in relation to the alcohol as if the duty were charged on the date of the sale or supply of the alcohol, and
 - (iii) V is the rate of value added tax chargeable in relation to the alcohol as if the value added tax were charged on the date of the sale or supply of the alcohol;
 - (c) "relevant person" means, in relation to premises in respect of which there is in force a premises licence -
 - (i) the holder of the premises licence,
 - (ii) the designated premises supervisor (if any) in respect of such a licence, or
 - (iii) the personal licence holder who makes or authorises a supply of alcohol under such a licence;
 - (d) "relevant person" means, in relation to premises in respect of which there is in force a club premises certificate, any member or officer of the club present on the premises in a capacity which enables the member or officer to prevent the supply in question; and
 - (e) "value added tax" means value added tax charged in accordance with the Value Added Tax Act 1994.
- 8(iii). Where the permitted price given by Paragraph 8(ii)(b) above would (apart from this paragraph) not be a whole number of pennies, the price given by that sub-paragraph shall be taken to be the price actually given by that sub-paragraph rounded up to the nearest penny.
- 8(iv). (1) Sub-paragraph 8(iv)(2) below applies where the permitted price given by Paragraph 8(ii)(b) above on a day ("the first day") would be different from the permitted price on the next day ("the second day") as a result of a change to the rate of duty or value added tax.
- (2) The permitted price which would apply on the first day applies to sales or supplies of alcohol which take place before the expiry of the period of 14 days beginning on the second day.

Conditions proposed by the Environmental Health (*agreed by applicant unless where stated*)

9. The supply of alcohol at the premises shall only to be a person seated taking a table meal there and for consumption by such a person as ancillary to their meal, save for private pre-booked functions, which shall be limited to the basement.
10. After 21.00 hours the licence use shall be limited to private pre-booked functions.
11. The supply of alcohol shall be by waiter or waitress service only.
12. Substantial food and suitable beverages other than intoxicating liquor shall be available during the whole permitted hours in all parts of the premises where intoxicating liquor is sold or supplied
13. The supply of alcohol shall be limited to beer and wine only.
14. There shall be consumption of alcohol outside the premises.
15. There shall be no self service of alcohol.
16. No noise generated on the premises, or by its associated plant or equipment, shall emanate from the premises nor vibration be transmitted through the structure of the premises which gives rise to a nuisance.
17. All windows and external doors shall be kept closed after 21:00 hours, or at any time when regulated entertainment takes place, except for the immediate access and egress of persons.
18. Notices shall be prominently displayed at all exits requesting patrons to respect the needs of local residents and businesses and leave the area quietly.
19. During the hours of operation of the premises, the licence holder shall ensure sufficient measures are in place to remove and prevent litter or waste arising or accumulating from customers in the area immediately outside the premises, and that this area shall be swept and or washed, and litter and sweepings collected and stored in accordance with the approved refuse storage arrangements by close of business.
20. No collections of waste or recycling materials (including bottles) from the premises shall take place between 23.00 and 08.00 on the following day.
21. No deliveries to the premises shall take place between 23.00 and 08.00 on the following day. (***not agreed by applicant***)
22. No rubbish, including bottles, shall be moved, removed or placed in the outside areas between 08.00 and 23.00 hours.
23. There shall be no cinema style seating provided at the premises. (***not agreed by applicant***)
24. The number of persons permitted in the premises at any one time (including staff). shall not exceed TBC persons overall
 1. Ground floor -TBC
 2. Basement - TBC

25. The approved arrangements at the premises, including means of escape provisions, emergency warning equipment, the electrical installation and mechanical equipment, shall at all material times be maintained in good condition and full working order.
26. The means of escape provided for the premises shall be maintained unobstructed, free of trip hazards, be immediately available and clearly identified in accordance with the plans provided.
27. All emergency exit doors shall be available at all material times without the use of a key, code, card or similar means.
28. All emergency doors shall be maintained effectively self closing and not held open other than by an approved device.
29. The edges of the treads of steps and stairways shall be maintained so as to be conspicuous.
30. Curtains and hangings shall be arranged so as not to obstruct emergency safety signs or emergency equipment.
31. All fabrics, curtains, drapes and similar features including materials used in finishing and furnishing shall be either non-combustible or be durably or inherently flame-retarded fabric. Any fabrics used in escape routes (other than foyers), entertainment areas or function rooms, shall be non-combustible.
32. The certificates listed below shall be submitted to the licensing authority upon written request.
 - a. Any permanent or temporary emergency lighting battery or system
 - b. Any permanent or temporary electrical installation
 - c. Any permanent or temporary emergency warning system
33. Any special effects or mechanical installations shall be arranged, operated and stored so as to minimise any risk to the safety of those using the premises. The following special effects will only be used on 10 days prior notice being given to the licensing authority where consent has not previously been given. • dry ice and cryogenic fog • smoke machines and fog generators • pyrotechnics including fireworks • firearms • lasers • explosives and highly flammable substances. • real flame. • strobe lighting.
34. A Challenge 21 proof of age scheme shall be operated at the premises where the only acceptable forms of identification are recognised photographic identification cards, such as a driving licence, passport or proof of age card with the PASS Hologram.
35. No licensable activities shall take place at the premises until the premises has been assessed as satisfactory by the Environmental Health Consultation Team at which time this condition shall be removed from the Licence by the licensing authority.

Conditions proposed by the Police (agreed by applicant)

36. The premises shall install and maintain a comprehensive CCTV system as per the minimum requirements of the Westminster Police Licensing Team. All entry and exit points will be covered enabling frontal identification of every person entering in any light condition. The CCTV system shall continually record whilst the premises is open for licensable activities and during all times when customers remain on the premises. All recordings shall be stored for a minimum period of 31 days with date and time stamping. Viewing of recordings shall be made available immediately upon the request of Police or authorised officer throughout the preceding 31 day period.

37. A staff member from the premises who is conversant with the operation of the CCTV system shall be on the premises at all times when the premises is open. This staff member must be able to provide a Police or authorised council officer copies of recent CCTV images or data with the absolute minimum of delay when requested.
38. A record shall be kept detailing all refused sales of alcohol. The record should include the date and time of the refused sale and the name of the member of staff who refused the sale. The record shall be available for inspection at the premises by the police or an authorised officer of the City Council at all times whilst the premises is open.

Premises within 75 metres of: Basement and Ground Floor, 4 Noel Street, London W1F 8GB

p / n	Name of Premises	Premises Address	Opening Hours
24650	Berwick News	First Floor 37 Berwick Street London W1F 8RS	Monday to Saturday 08:00 - 23:00 Sunday 10:00 - 22:30
15997	Oxford Street Youth Hostel	Second Floor 5A Noel Street London W1F 8GE	Monday to Sunday 00:00 - 00:00
12734	BRGR	Third Floor To Fourth Floor 181 Wardour Street London W1F 8WZ	Monday to Saturday 10:00 - 01:30 Sunday 12:00 - 00:00
27167	Imli Ltd	171 Wardour Street London W1F 8WL	Sunday 08:00 - 00:00 Monday to Saturday 08:00 - 01:00
-4595	Peter Stringfellows' Angels Soho	Rooms 21 And 22 Second Floor 189 Wardour Street London W1F 8ZD	Sunday 10:00 - 00:30 Monday to Saturday 10:00 - 06:00
-13350	Blanchette	Basement And Ground Floor 8 D'Arblay Street London W1F 8DP	Monday to Saturday 10:00 - 00:30 Monday to Saturday 10:00 - 23:30 Sunday 12:00 - 00:00 Sunday 12:00 - 23:00
-17793	Chipotle Mexican Grill	181 Wardour Street London W1F 8WZ	Monday to Saturday 10:00 - 23:30 Sunday 11:30 - 23:00
29658	Franco Manca	Basement 50 - 51 Berwick Street London W1F 8SJ	Monday to Saturday 11:00 - 00:00 Sunday 11:00 - 23:00
-18838	The Real Creek	Ground Floor 47 Berwick Street London W1F 8SJ	Monday to Saturday 11:00 - 00:00 Sunday 11:00 - 23:00
-25102	Old Tom & English	Fourth Floor 181 Wardour Street London W1F 8WZ	Monday to Thursday 11:00 - 00:00 Friday to Saturday 11:00 - 00:30 Sunday 12:00 - 23:00
-14560	Inamo	Basement To First Floor Prince Wardour House 195 - 197 Wardour Street London W1F 8ZQ	Friday to Saturday 10:00 - 00:00 Monday to Thursday 10:00 - 23:30 Sundays before Bank Holidays 12:00 - 00:00 Sunday 12:00 - 22:30
-216	Bukowski	Flat 3 9 D'Arblay Street London W1F 8DR	Monday to Sunday 12:00 - 23:30
-9676	Raj Tandoori Restaurant	70 Berwick Street London W1F 8TA	Monday to Saturday 10:00 - 00:30 Sunday 12:00 - 00:00
-15717	Korkers (Basement) And Mustafa's Thai Cottage (Ground Floor)	Flat 2 33 D'Arblay Street London W1F 8EU	Monday to Saturday 09:00 - 03:30 Monday to Saturday 10:00 - 00:30 Sunday 12:00 - 00:00 Sunday 12:00 - 00:00
-1175	Cookhouse Joe	Flat 1 50 Berwick Street London W1F 8SJ	Monday to Thursday 08:00 - 00:00 Friday to Saturday 08:00 - 00:30 Sunday 10:00 - 23:00

APPENDIX 6



02/11/2015 15:52:05

StampThePhoto from ArvanSoft



timber
yard

timber
yard

02/11/2015 15:50:41

StampThePhoto from ArvanSoft



If you have any queries about this report or wish to inspect one of the background papers please contact the report author.

Background Documents – Local Government (Access to Information) Act 1972

1	Licensing Act 2003	N/A
2	City of Westminster Statement of Licensing Policy	7 th January 2011
3	Amended Guidance issued under section 182 of the Licensing Act 2003	March 2015
4	Application Form	2 nd September 2015
5		
6		
7		
8		
9		
10		
11		
12		
13		
14		
15		
16		
17		
18		
19		
20		
21		
22		
23		
24		